

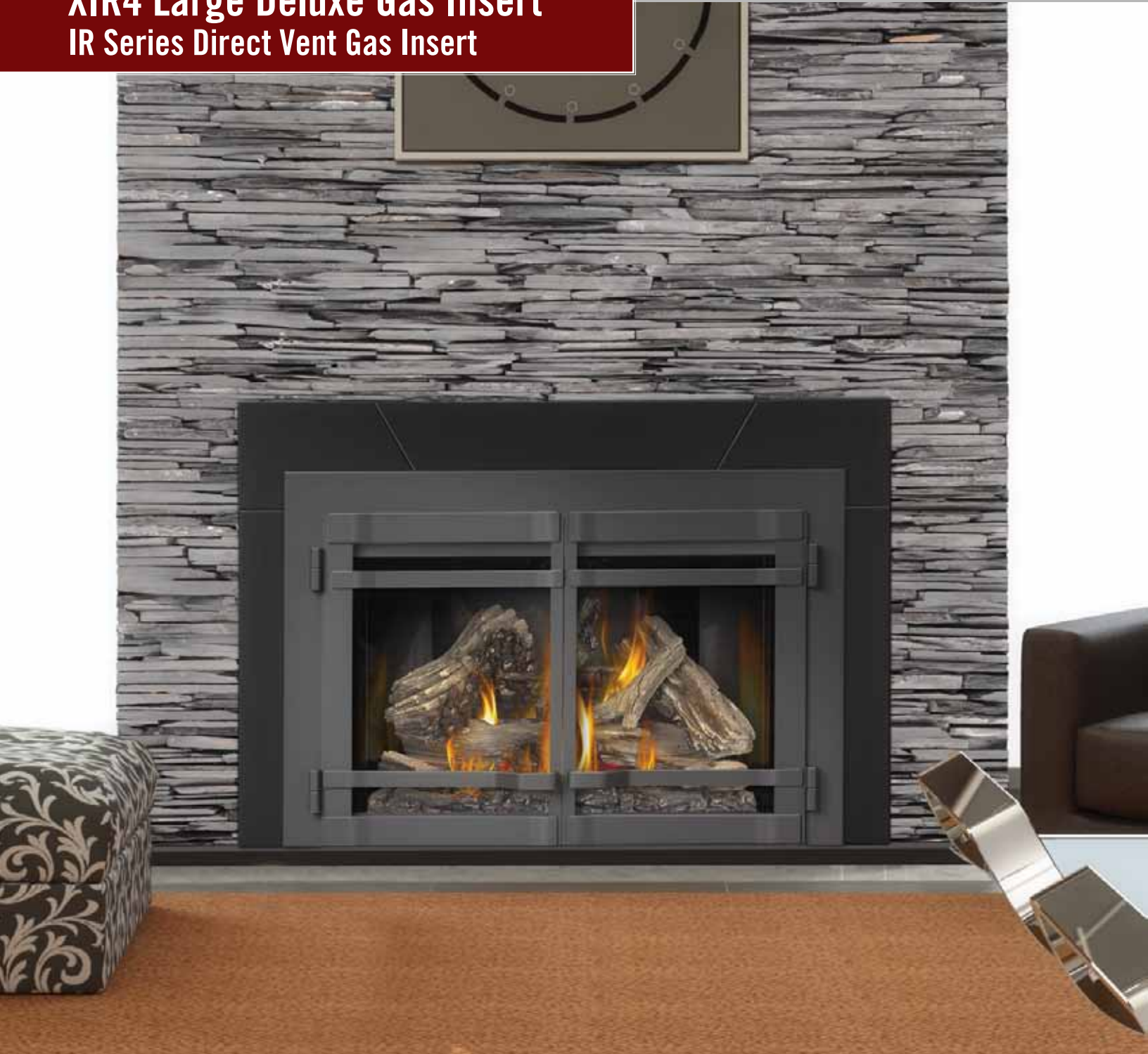

**XIR4 Large Deluxe Gas Insert  
IR Series Direct Vent Gas Insert**



For more information or to place an order call 1-800-461-5581 or visit [napoleonfireplaces.com](http://napoleonfireplaces.com)

# XIR4 Large Deluxe Gas Insert IR Series Direct Vent Gas Insert

Napoleon® – Providing some of the highest infrared (IR) heat in the industry. Our new IR series direct vent gas inserts feature Napoleon's advanced infrared technology and flame modulation. The new XIR gas inserts offer a modulating dual burner system that results in a firebox filled with a stunning triple flame pattern.

The impressive XIR4 deluxe direct vent gas insert entertains a new level of fire and comfort. With up to 40,000 BTU's and an impressive clean face viewing area, it is a perfect choice for larger rooms where a passion for luxury is evident. Style, comfort and efficiency – the IR Series has it all.

## Napoleon® Exclusive Features

- Exclusive dual burner system allows for full modulation of both front and rear burners from 16,000 up to 40,000 BTU's for maximum heat/flame adjustment
- Front burner can be modulated independently from 16,000 to 22,000 BTU's
- Realistic PHAZER® logs fill the impressively large firebox
- Fuel saving electronic ignition with battery back-up
- Clean face design with a 563 sq. in. viewing area
- Heat radiating ceramic glass
- Exclusive NIGHT LIGHT™ comes standard
- Thermostatic remote control comes standard
- Heat circulating blower comes standard

## Napoleon® Options/Accessories

- Optional decorative accessories
- Optional ACS - anti condensation switch (standing or intermittent pilot)
- Optional safety screen
- Optional Newport™ and Old England decorative brick panels
- Optional Porcelain Reflective Radiant Panels

## Installation

- 3" exhaust / 3" air intake
- Minimum fireplace opening: 34¼" w x 17" d x 25" h

## Line Drawings

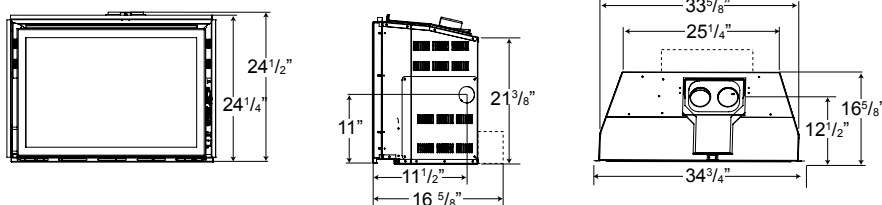

Model	BTU's	Venting	Height		Width		Depth		Glass Size		Glass Type	Blower	Mobile Home Certified
			Actual	Min. Opening	Actual	Min. Opening	Actual	Min. Opening	Height	Width			
XIR4	16,000-40,000	Top	24 1/2"	25"	34 3/4"	34 1/4"	16 5/8"	17"	20 5/8"	31"	Ceramic	Standard	Yes

Line dimensions and measurements are to be used as a guide only. Please consult your installation manual for updated and precise measurements before proceeding to install or frame your Napoleon® Fireplace. Tested in Canada and the U.S. to CSA 2.33, ANSI Z21.88 FOR VENTED GAS FIREPLACE HEATERS.

Consult your owner's manual for complete installation instructions, accurate framing dimensions and proper clearances to combustible material. Check all local and national building code regulations. All specifications are subject to change without prior notice due to on-going product improvements. Products may not be exactly as shown. Napoleon® is a registered trademark of Wolf Steel Ltd. © Wolf Steel Ltd.



**Above and Cover:**  
XIR4 shown with five piece painted black surround, wrought iron door kit in painted black and Porcelain Reflective Radiant Panels.

## Features/Options/Accessories



### Firebox Panel Options

Porcelain Reflective Radiant Panels, Old England Grey and Newport™ Deluxe decorative brick panels available.



### Safety Screen

Safety screens are available to protect children, adults and pets from touching the hot glass surface.



### Decorative Doors and Fronts

A multitude of designer options including doors and fronts in various finishes are available to create the exact statement you have been looking for.



- 103 Miller Drive, Crittenden, Kentucky, USA 41030
- 24 Napoleon Road, Barrie, Ontario, Canada L4M 0G8
- 7200 Trans Canada Highway, Montreal, Quebec, Canada H4T 1A3

Tel: 705-721-1212 Fax: 705-722-6031  
napoleonfireplaces.com



Authorized Dealer